

Chapter 47: Vented Ridge Cap

Most Common Mistakes:

1. Setting ridge cap other than to stringlines.
2. Omitting vented closure strips.
3. Trying to avoid vented closures overhanging roof steel top edge.
4. Overlooking caulking between overlaps.
5. Roofing overhangs at eave sides too far.

See Figure 47-1 and Figure 47-2

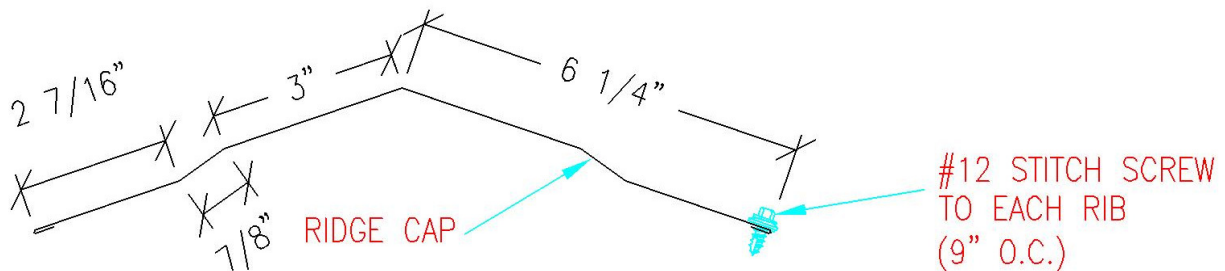

Figure 47-1: Ridge Cap – Central States, McElroy, & Union Corrugating

Central States : RCP (6-3/4" each side)

McElroy: P-RC-13 shown

Union Corrugating : RC14H (6-5/8" each side)

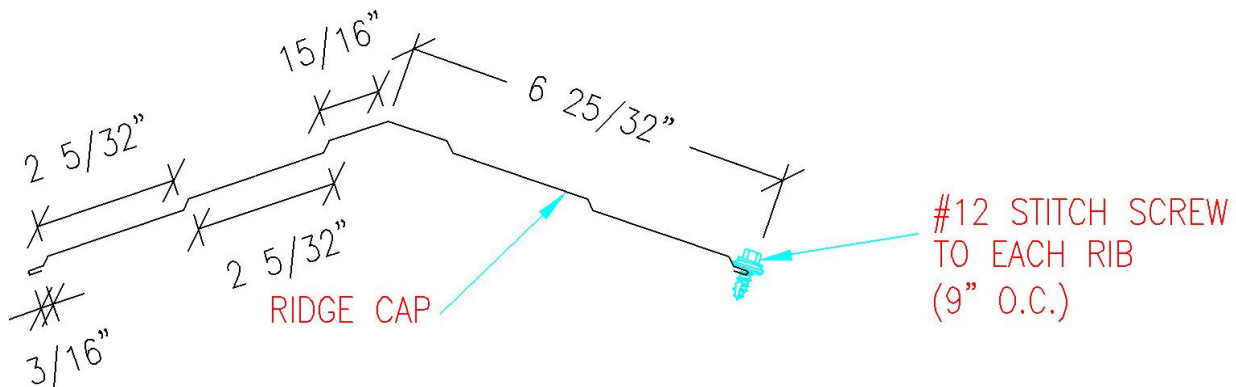

Figure 47-2: Ridge Cap – ABC, Fabral, & Metal Sales

(Sizes and design vary by vendor)

ABC: LG-101

Fabral: AR-3 shown

Metal Sales: Part #42023

Ridge Cap sizes, design and terminology vary from manufacturer to manufacturer. Some producers label their trims by actual width of steel flat sheet trim is manufactured from.

Place a Ridge Cap piece centered on building peak. Make a pencil mark at lower edges at both building ends, on end truss/rafter or fly rafter tops. Partially drive nails at these marks and run stringlines from end-to-end of building and attach to nail heads. Stringlines will make Ridge Cap easier to align and provide a measuring point for locating form-fitted VENTED outside closure strips.

Press Outside VENTED Closure Strips into place, along building length, on both sides of peak.

If building has overhangs past one of both endwalls, closures in overhang areas will be solid Outside Closures. Closure low edge will be $\frac{1}{2}$ " or so up from string line (confirm Ridge Cap will cover low edge of closure when installed).

Cut off any closure within 2-1/4" of outside edge of endwall framing. (Any closure in this area will interfere with rake trim.)



Any cutoff closure strip portions can be placed between rake trim peak and ridge cap at each building end (on top of rake trim, under ridge cap).

Install first Ridge Cap piece on peak at building back, allowing an overhang beyond end truss/rafter or fly rafter by 2-1/2". **See Figure 47-4**

Fasten with #12x1-1/4" stitch screws through ridge cap edge flange and VENTED closure strips into all roof steel high ribs. Because stitch screws attach ridge cap directly to steel roofing, ridge purlin location has no effect on ridge cap installation.

Run two caulk beads at first Ridge Cap piece end to seal to next overlapping Ridge Cap. Lap next Ridge Cap a 3" minimum over first. Press seams together and so on down building. Trim last piece, if necessary, to overhang either end truss/rafter or fly rafter by 2-1/2" at building front end.

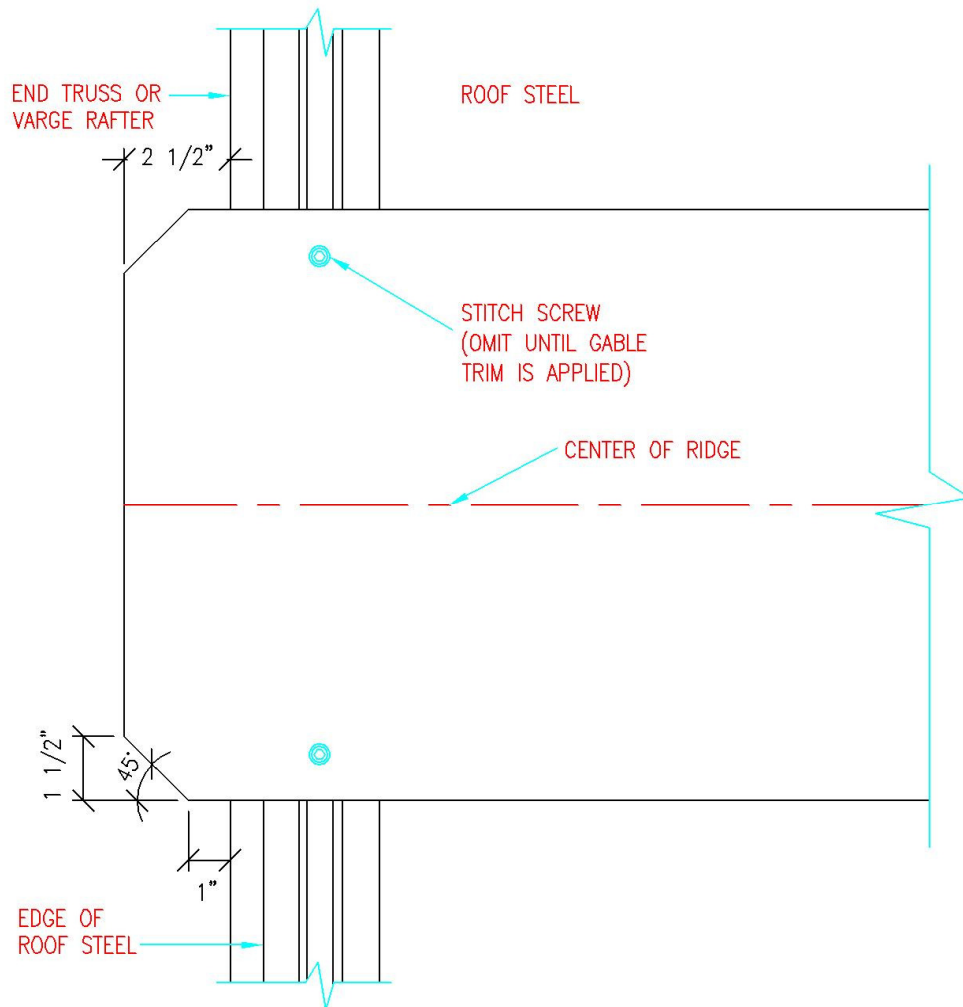

Figure 47-4: Ridge Cap at Endwall (Plan View)

Trim a 45 degree angle 1-1/2" from each overhanging ridge cap corner. Place last (closest to building ends) stitch screws only after rake trim has been installed.

Clean roof after installation. Swarf left on steel surfaces will cause unsightly rust stains and lead to a reduced life span. Sweep or hose all metallic swarf and other debris from roof areas at each day end and at construction completion. Remove any swarf stuck on a finish. Take great care to avoid removing paint or metal coatings. Inspect again two weeks after completion, when rain or condensation will have caused any remaining swarf to rust, and thus highlight affected areas.